



6020 N Deep groove ball bearings

- SKF Explorer

Deep groove ball bearings

Bearing data

[Tolerances](#),

Normal (metric), P6, P5, Normal (inch),

[Radial internal clearance](#),

Matched bearing pairs, Stainless steel
d < 10 mm, Other bearings

Bearing interfaces

[Seat tolerances for standard conditions](#),

[Tolerances and resultant fits](#)

Technical specification

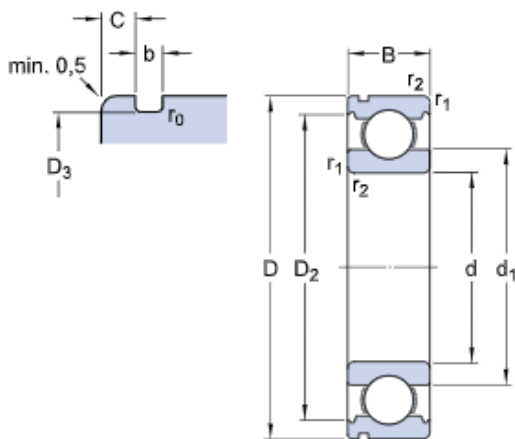

DIMENSIONS

d	100 mm	Bore diameter
D	150 mm	Outside diameter
B	24 mm	Width
d_1	≈ 115.95 mm	Shoulder diameter
D_2	≈ 138.3 mm	Recess diameter
D_3	145.24 mm	Diameter of snap ring groove
b	3.1 mm	Width of snap ring groove
C	3.71 mm	Distance outer ring from side face to snap ring groove
r_0	max. 0.6 mm	Bottom radius of snap ring groove
$r_{1,2}$	min. 1.5 mm	Chamfer dimension

ABUTMENT DIMENSIONS

d_a	min. 107 mm	Diameter of shaft abutment
D_a	max. 143 mm	Diameter of housing abutment
D_b	min. 162 mm	Diameter of snap ring recess in the housing
b_a	min. 3.5 mm	Width of snap ring recess in the housing

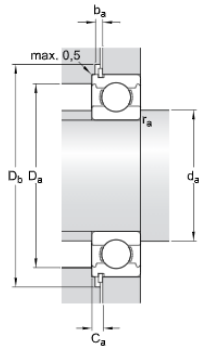

C_a	max. 6.53 mm	Distance from outer ring side face to snap ring back face
r_a	max. 1.5 mm	Radius of shaft or housing fillet

CALCULATION DATA

C	63.7 kN	Basic dynamic load rating
C_0	54 kN	Basic static load rating
P_u	2.04 kN	Fatigue load limit
	9 500 r/min	Reference speed
	5 600 r/min	Limiting speed
k_r	0.025	Minimum load factor
f_0	16	Calculation factor

MASS

	1.24 kg	Mass bearing
--	---------	--------------

TOLERANCE CLASS

P6	Dimensional tolerances
Normal	Radial run-out